

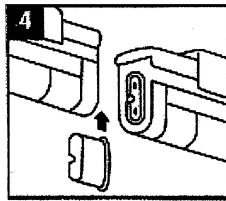

## #12 UNDERCABINET (22 Series) ULTRA-SLIM T5

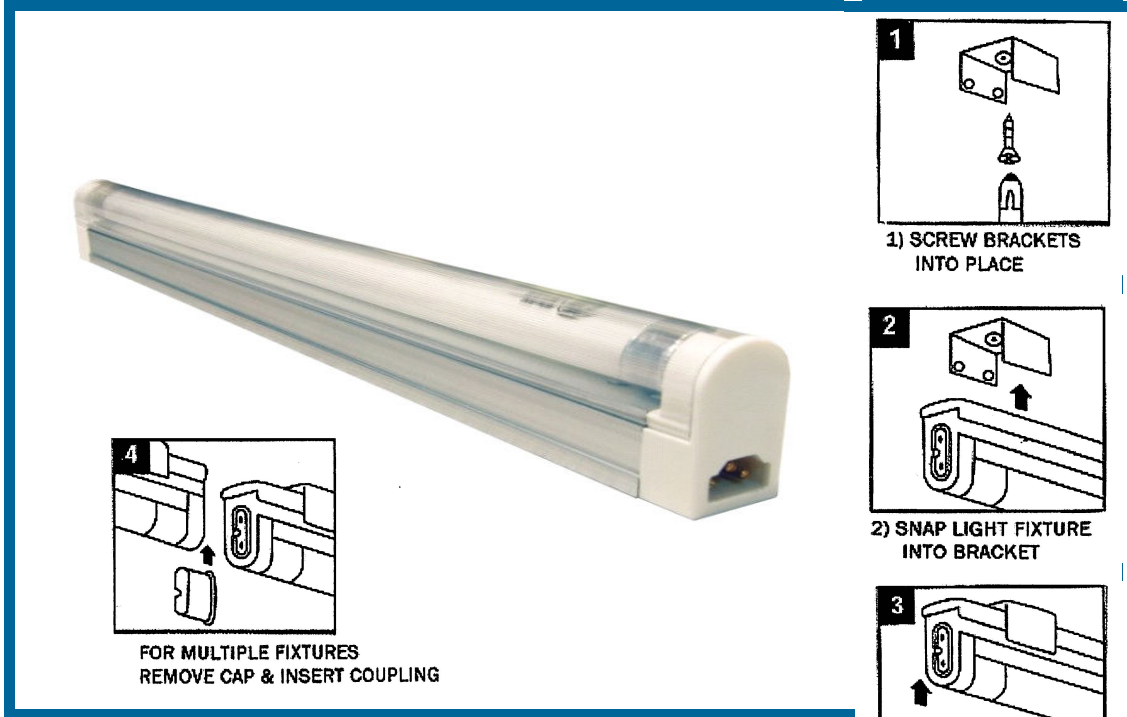

*Designed for Kitchens, Showcases, Displays, Hard to Fit Places*



FOR MULTIPLE FIXTURES  
REMOVE CAP & INSERT COUPLING

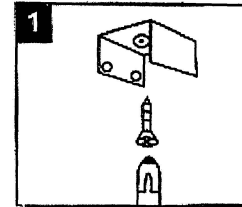

1) SCREW BRACKETS  
INTO PLACE

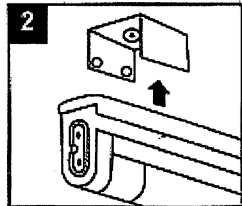

2) SNAP LIGHT FIXTURE  
INTO BRACKET

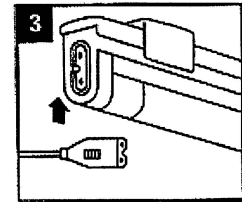

3) CONNECT CORD

### Options:

6-in & 12" joiner  
cables  
Various temp Lamps

### Features:

- Easy Mounting Clips. Plexiglass Lamp Cover
- Built-in Switch
- Linkable up to 10 lamps (8w–20w)
- Linkable up to 5 lamps (24w and 28w)
- Width 7/8" H x 1-11/16" W
- Fixture individually boxed.

### ORDERING DATA

E. B. NUMBER	LAMP	DIMENSIONS
#12 1/8	1- F8 T5	13-1/2" LONG
#12 1/14	1- F14 T5	23-5/8" LONG
#12 1/21	1- F21 T5	35-5/8" LONG
#12 1/28	1- F28 T5	47.5" LONG

### E. B. LIGHTING & SUPPLIES, INC.

1107 East Baltimore St., Baltimore MD 21202

410-276-7617

fax: 410-276-7307